

FILTRA PRO INOX & DESIGN

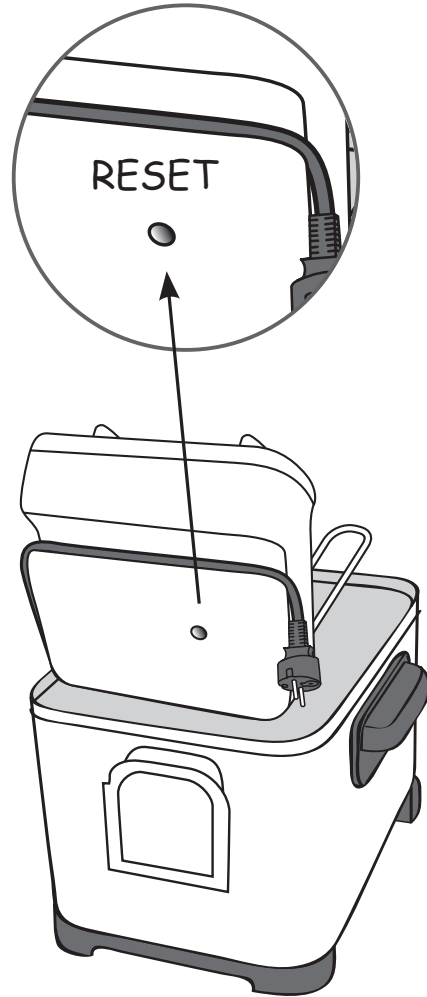

www.groupeseb.com

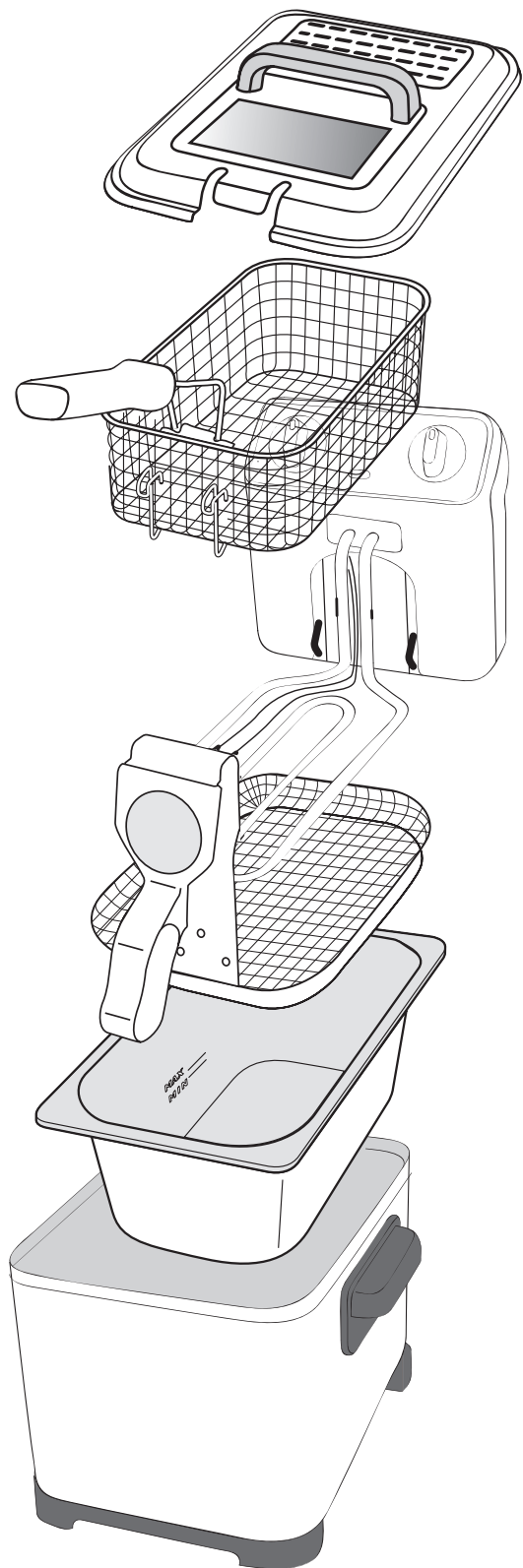



1

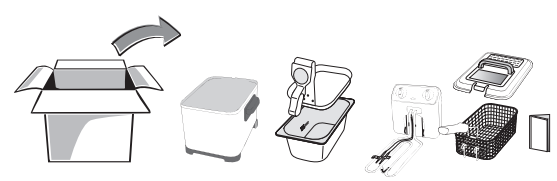
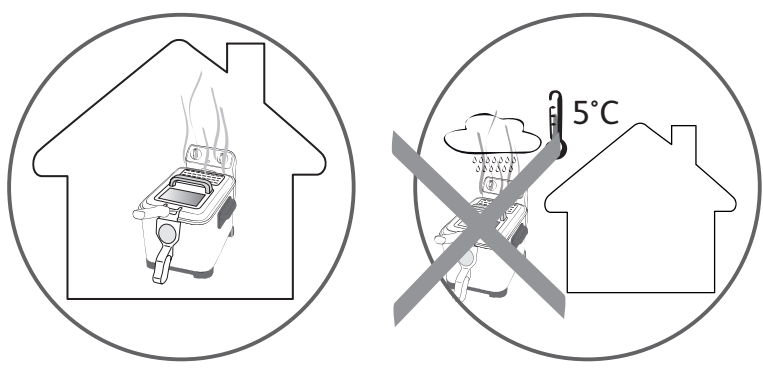

2

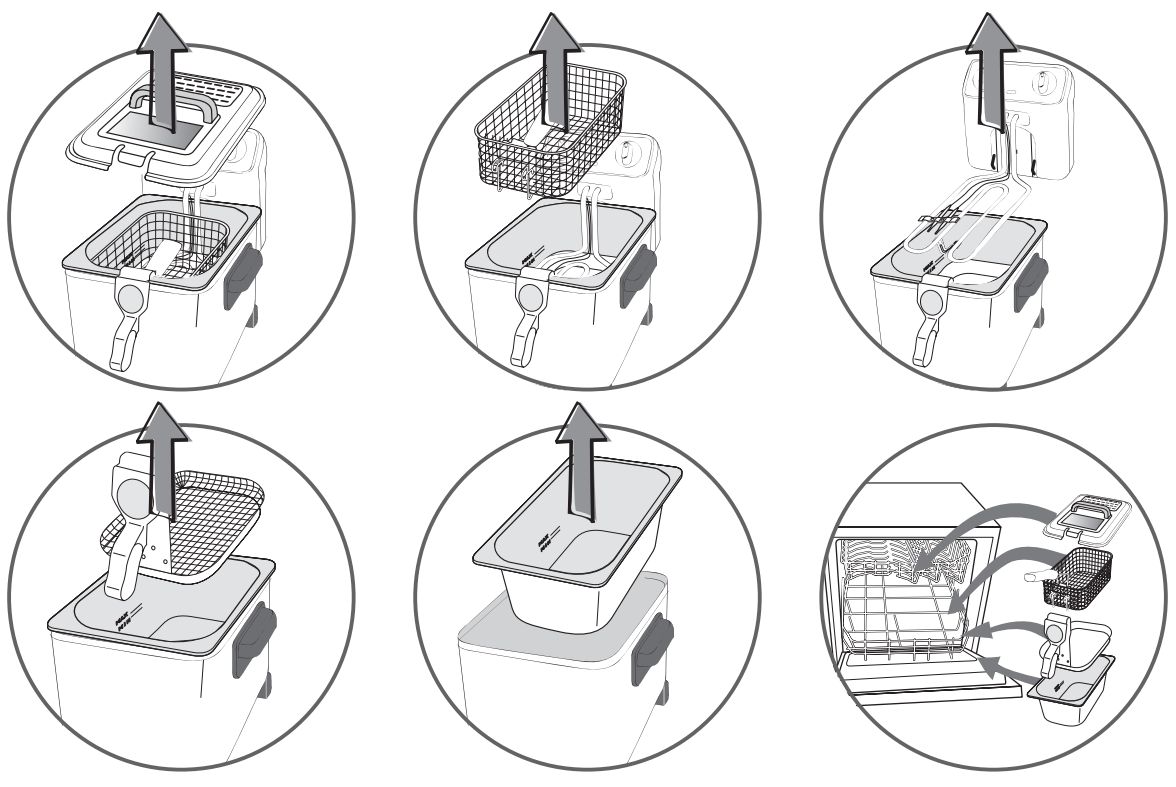

3

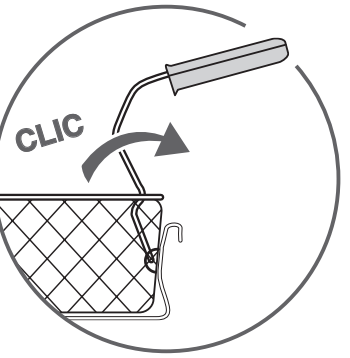
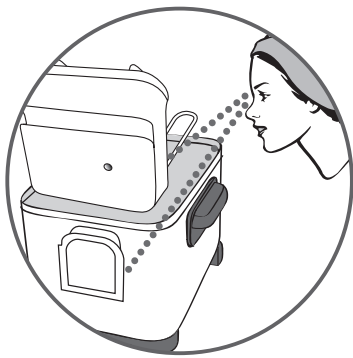
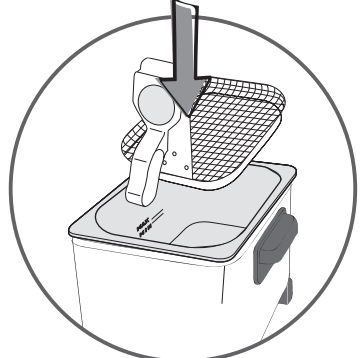
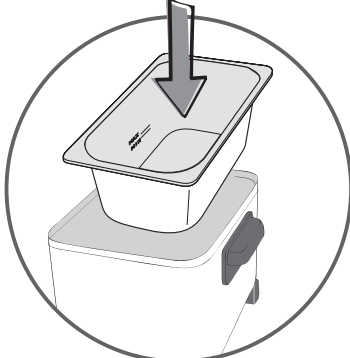
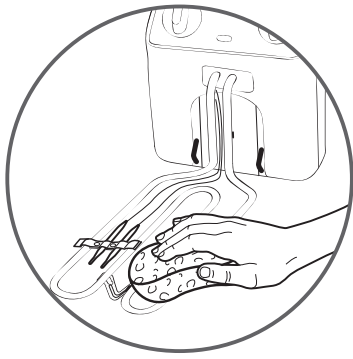



Min.	3,3L
Max.	4L

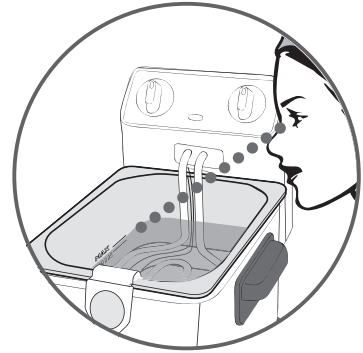
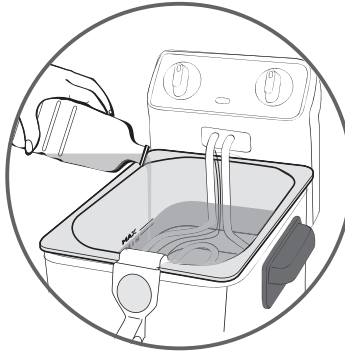

Min.	2890g
Max.	3500g

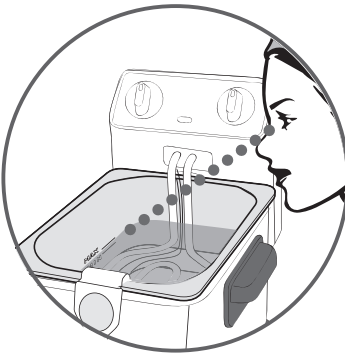
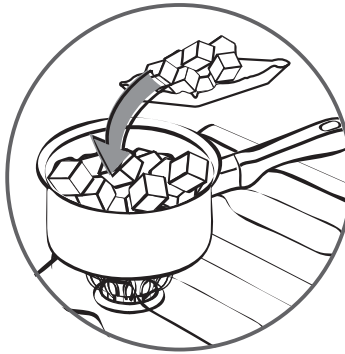

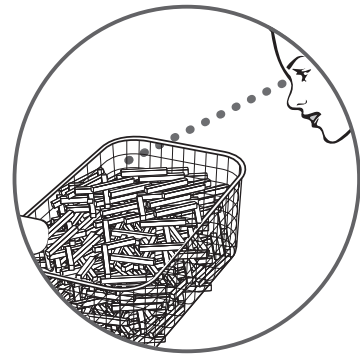
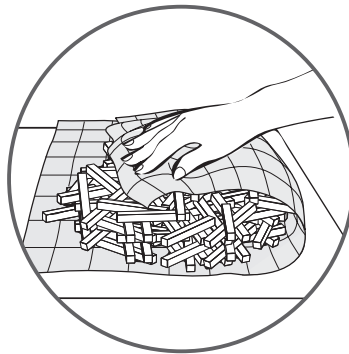
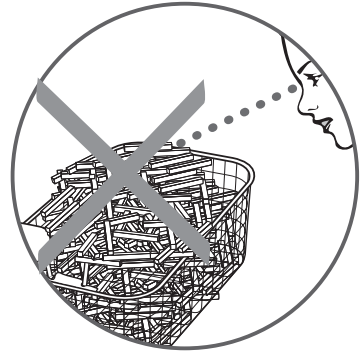
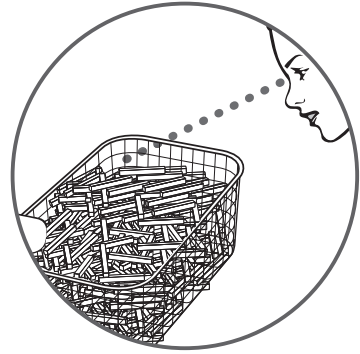
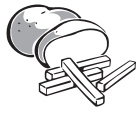
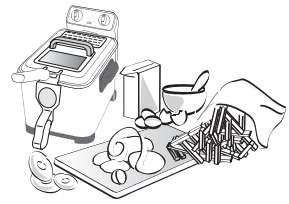

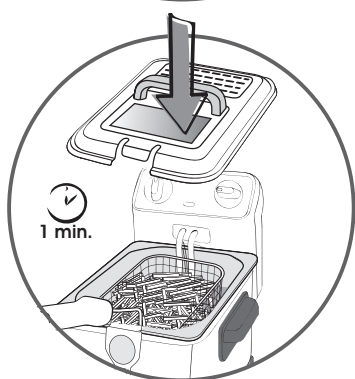
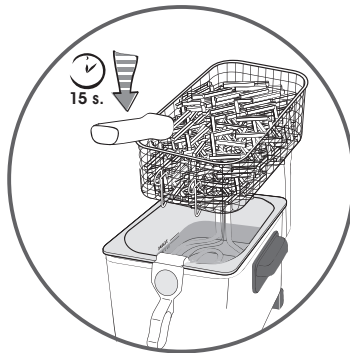
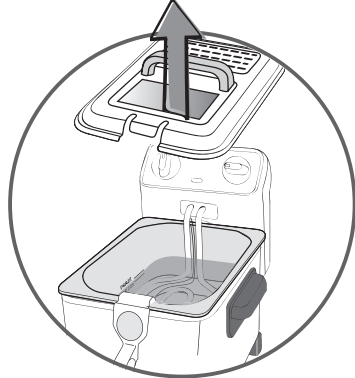
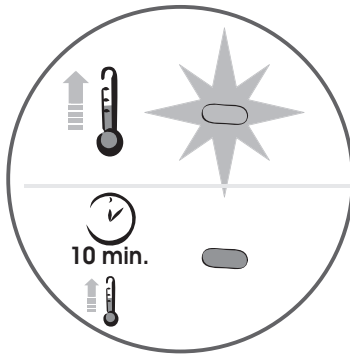
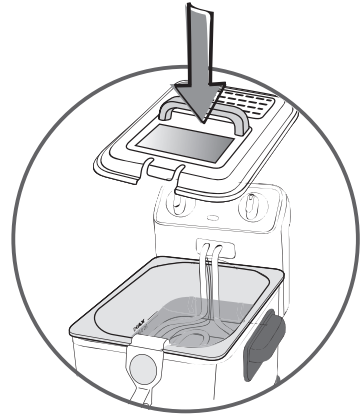
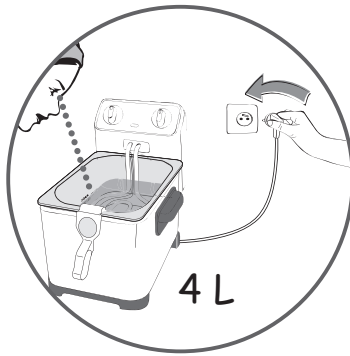

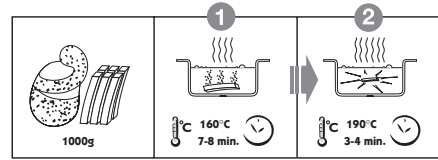

	Nb		°C	
		1000g	① 160°C	7-8 min.
			② 190°C	3-4 min.
		600g	170°C	9-10 min.
		800g	180°C	9-10 min.
		400g	160°C	4-6 min.
	8-9		170°C	3-4 min.
* * *			°C	
		450g	170°C	7 min.
		900g	190°C	8 min.
	12		190°C	4-5 min.
		1300g	190°C	6 min.
	10-12		190°C	4-6 min.



7

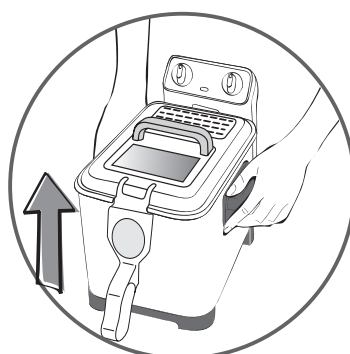
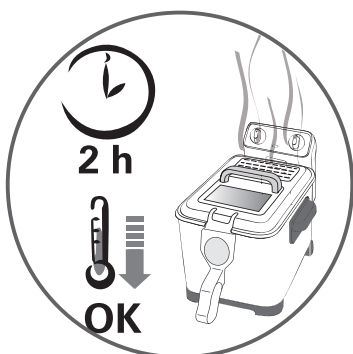
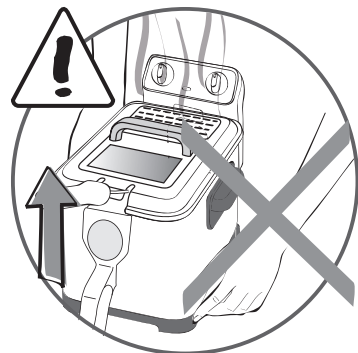
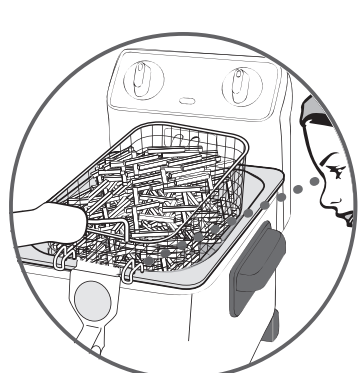
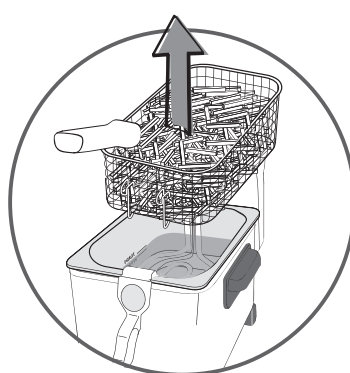
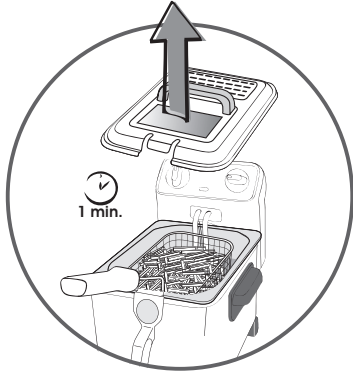

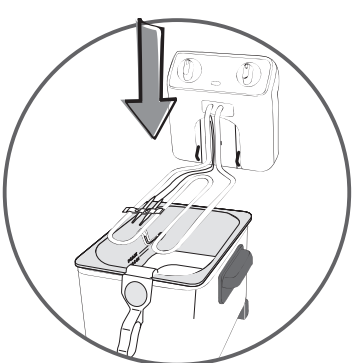
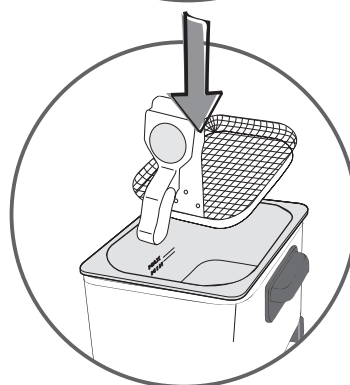
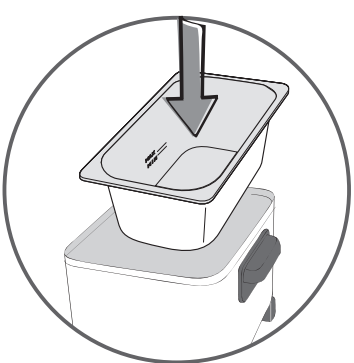
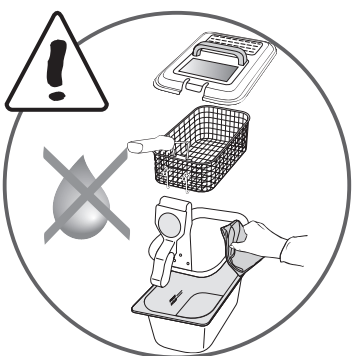
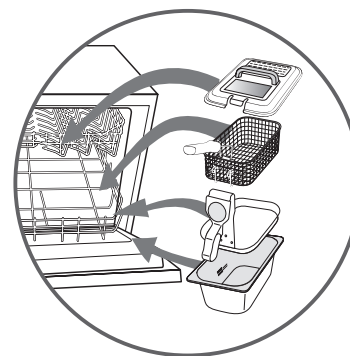
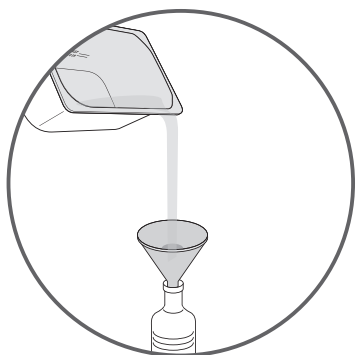
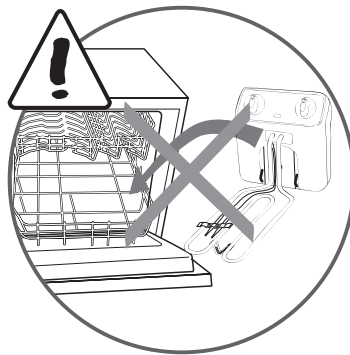
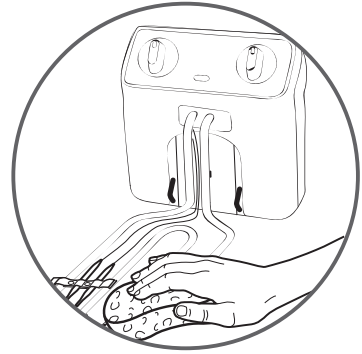
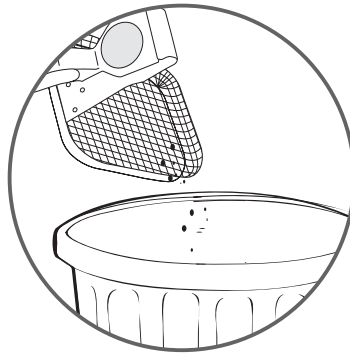
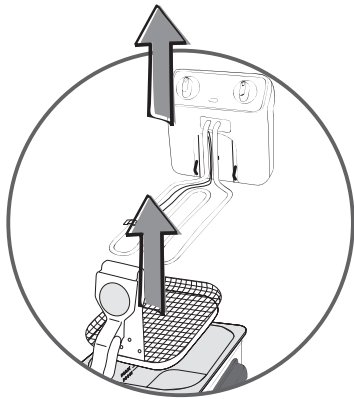
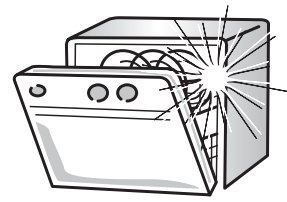

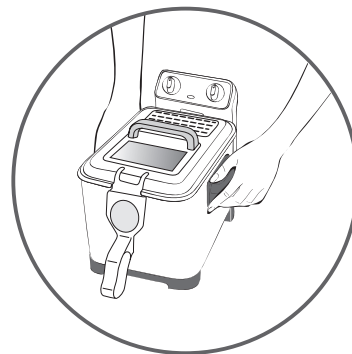
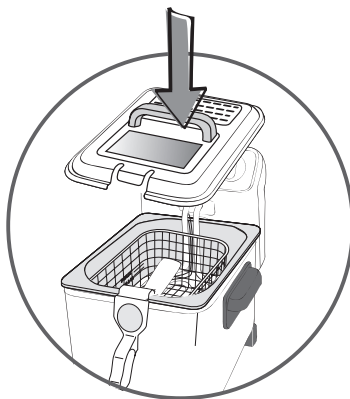
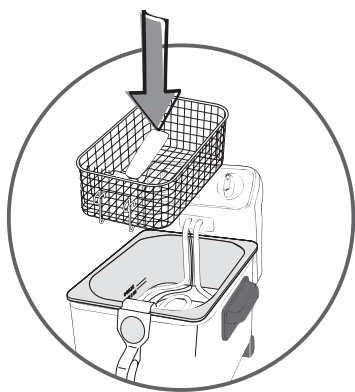

9

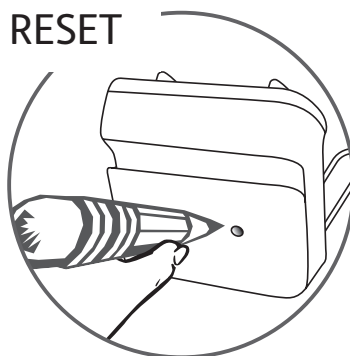
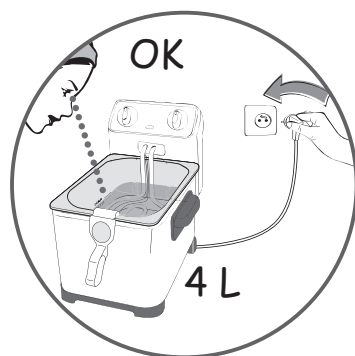
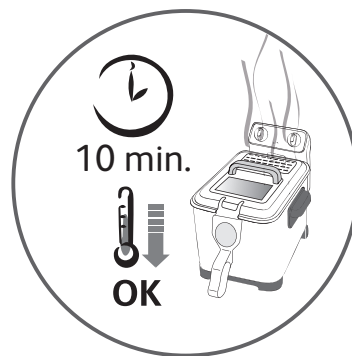
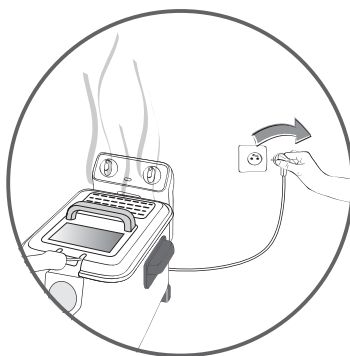
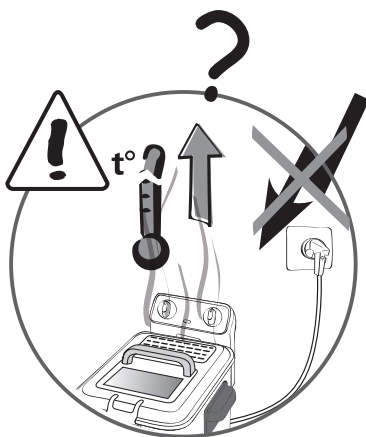



10

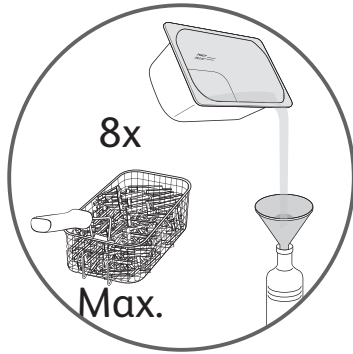

11



Ref : NC00018948
Conception : www.batoteam.fr